

## SR41 Sealed Rivet

Dome head · Stainless steel body · Stainless steel stem · Sealed  
3.2 mm (1/8") - 4.8 mm (3/16")

### Features

- Fully sealed and weather proof, sealed against moisture air and other contaminants
- Good hole fill and retained stem provide strong vibration resistant joints
- Higher tensile and shear strength than equivalent open end rivets

### Material

- Body: Stainless steel 304, polished
- Stem: Stainless steel 304, polished

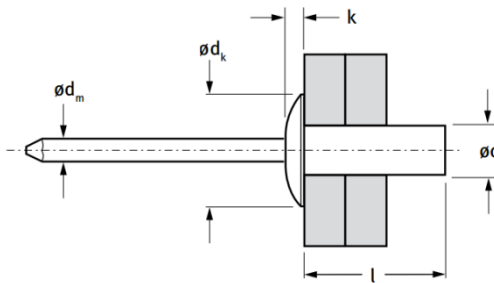

Before Placement

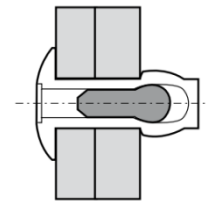

After Placement

Part No.	Size ø	Grip Range		Hole Size	ød	l	ød <sub>k</sub>	k	ød <sub>m</sub>	Shear (typical) kN	Tension (typical) kN
		min.	max.								
OSR41-03260	3.2 (1/8")	0.5	1.5	3.3	3.2	6.0	6.0 [±0.24]	1.4	1.9	2.0	2.5
OSR41-03280		1.5	3.0			8.0					
OSR41-03210		3.0	5.0			9.5					
OSR41-03212		5.0	7.0			12.0					
OSR41-04060	4.0 (5/32")	0.5	1.5	4.1	4.0	6.0	8.0 [±0.29]	1.7	2.3	3.0	4.0
OSR41-04080		1.5	3.0			8.0					
OSR41-04095		3.0	5.0			9.5					
OSR41-04012		5.0	6.5			12.0					
OSR41-04016		6.5	10.5			16.0					
OSR41-04880	4.8 (3/16")	1.0	3.0	4.9	4.8	8.0	9.5 [±0.29]	2.0	2.9	4.5	5.5
OSR41-04895		3.0	5.0			9.5					
OSR41-04812		5.0	6.5			12.0					
OSR41-04816		6.5	10.5			16.0					
OSR41-04820		10.5	14.0			20.0					